

Technical Specifications

Salle Léo-Poulin



Partenaires:



Created by Nord 8

300 Martin street
Edmundston NB E3V 2N6

Director of the Salle Léo-Poulin

Jocelyn Cyr, Vice-principal, Cité des Jeunes A.-M.-Sormany
506.735.2008 / Jocelyn.Cyr@nbed.nb.ca

Promoter, Centre des Arts, city of Edmundston

Christine Lavoie, arts coordinator and director of the Centre des arts
506.739.2127 / christine.lavoie@edmundston.ca

Technical director

Max Collin
506.740.0990 / max.tech.cdj@gmail.com

Technical services

Technical director is on site at all times.

Technicians on site upon request :

- Head sound technician
- Head lighting technician
- Assistant technician, technical team of the Cité des Jeunes

Material available, but with additional fees :

- 12-foot grand piano, Steinway & Son, Model D – serial number 445173, built in 1976, full restoration in 2014, equipped with C-Ducer microphones.
- Hazer MDG ATMe
- Projectors with 16 : 9 screens each side of the stage via VGA and HDMI from FOH.
- Sound system
- Lighting system
- Follow spot (operator needed)
- Batteries AAA, AA, 9V

Connections available for audio-video presentations, VGA, and HDMI from FOH.



Specifications of the hall

- Hall capacity: 520 seats
- Balcony capacity: 239 seats
- Seat width: 20", 21" 22", 23"
- Distance between seats: 16"
- **Five (5) spaces are specifically reserved for wheelchairs on the main floor.**
- Access to the stage by means of stairways (stage right and stage left)
- Dimensions (taken from the center of the auditorium):
 - ❖ Distance from stage curtain to wall at the back of the auditorium: 18,793 mm (61'7")
 - ❖ Width of the front of the auditorium: 21,924 mm (71'11")
 - ❖ Height under the balcony: 2,260 mm (89")
 - ❖ Distance of seat nearest to edge of stage: 2,184 mm (86")

Specifications of the stage

- Opening of proscenium : 14 698mm (48'2")
- Total depth of the stage (excluding the apron) : 6 949mm (22' 8")
- Dimensions from the edge of stage (apron) : 1 981mm (6'5")
- Total depth of the stage (including the apron) : 8 831mm (29'3")
- Total width of stage : 20 534mm (67' 4")
- Height from floor under the proscenium : 4 800mm (15'9")
- Height from floor to first obstruction to ceiling : 4 800mm (15'9")
- Wings (stage right)
 - ❖ Width 2 801 mm (9'2")
 - ❖ Depth 6 872 mm (22'6")
- Wings (stage left)
 - ❖ Width 3 035 mm (9'11")
 - ❖ Depth 6 872 mm (22'6")
- Floor covered with linoleum on wood (under structure composed of frames and concrete subfloor)

Dressing rooms and ticketing services

Two (2) dressing rooms with private bathrooms, mirror, sink, sofa. Room for five (5) persons.
One (1) reception area for fifty (50) people, backstage.

A ticketing counter is available at the front of the hall. The Cité des jeunes A.-M.-Sormany is not responsible for ticket sales.

Hanging and Rigging

System of 15 double brake electric chain hoists made by ChainMaster with load limiter of 500 kg and a digital remote control. Everything is operated by technicians appointed by the administration of the hall.

MM	Feet	Serial	Description	Specifications
-12780	-42'		3 electrics for FOH on 2-inch pipes	Fixed Total 15 dimmer channels 2.4kW 5 channels per electric
-8135	-26'8"		12 inch square truss FOH	Fixed, not available for additional fixtures. 5x Source 4 Zoom 15/30 permanently installed for FOH
-300	-1'	0	Curtains and main valances	Opens manually, stage right
440	1'5"	1	First electric on 12-inch square truss	14m (46'), 500kg max
1080	3'7"	2	Single electric chain hoist on center	250kg max, for decors & accessories
1700	5'7"	3	Valance	Adjustable
2700	8'10"	4	12 inch square truss	14m (46'), 500kg max
3400	11'2"	5	Valance	Fixed
4400	14'5"	6	Second electric on 12-inch square truss	14m (46'), 500kg max
5200	17'1"	7	Valance	Adjustable
5750	18'10"	8	Third electric on 12-inch square truss	10.5m (34'), 500kg max
6400	21'	9	Upstage curtain	Opens manually, stage right
6550	21'6"	10	Creamy white cyclorama (muslin)	Fixed to the wall

Stage dressing

PLASTER LINE CURTAIN

Black curtain - 21 ounces

Opens manually - stage right

UPSTAGE CURTAIN

Black curtain - 21 ounces

Opens manually - stage right

CYCLORAMA

Creamy white muslin cyclorama - 40' x 18'

MASKING CURTAINS

6 portable curtains for backstage on both sides of the stage

**** Under no consideration will the tenant be allowed to hang things on the cyclorama and curtains.**

Equipment

Electricity

- Receptacle, 40 amperes - single phase - stage left
- Cam-Lok E1016 plug, 200 amperes - three phase - stage right
- Cam-Lok E1016 plug, 150 amperes - three phase - stage right
- U-Ground 12-circuit 120V

Communication

- Dual-channel communication system (TELEX MS-2002)
- Two fixed intercom speaker stations at strategic locations in the hall (TELEX SS-2002)
- Total of 6 bodypacks and headsets available

Video

- Two (2) 9' x 12' motorized projector screens on each side of the stage
- Two (2) Optoma EH501 1080P HDMI, 5000 lumens ceiling-mounted projectors
- Kramer VP-728 Presentation Scaler 1, HDMI, VGA, component (fixed to control board)
- Apple TV
- Everything can be managed from the control board via HDMI or VGA and on stage via VGA.

Risers

- Four (4) _____ Aluminium platform 4' x 8' (1.2 x 2.4m)
- Four (4) _____ Set of six legs 16" (406mm)
- Deux (2) _____ Set of six legs 8" (203mm)

Computing

- One Apple 13.3" MacBook Pro 2014 computer, 4GB RAM, 500GB hard drive
- One HP 15.6" ProBook 450 G2 computer, Windows 10, 500GB hard drive
- Secure Internet access; It should be noted that some Websites are blocked. Please advise us of the sites you will need in order to do the necessary tests beforehand.

Lighting

Lighting desks (FOH)

- ETC Smart Fade 1296
- ETC CongoKid with touch screen

Dimmers

- Thirty-six (36)_____ Channels 2.4kW ETC Sensor
- Thirty (30)_____ Channels 2.4kW ETC Sensor 3
- Twelve (12)_____ Channels 600W Leprecon

Fixtures

- Seventeen (17)_____ Par64 MFL 1000W
- Six (6)_____ Six bar Par64 MFL 1000W
- Seven (7)_____ Ellipsoidal ETC S4 750W 26°
- Four (4)_____ Ellipsoidal ETC S4 750W 36°
- Eight (8)_____ Ellipsoidal ETC Varifocal S4 750W Zoom 15/35° (5 on FOH)
- Twelve (12)_____ Ellipsoidal ETC Varifocal S4 750W Zoom 25/50°
- Twelve (12)_____ PARnel ETC S4 750W with barn doors
- One (1)_____ PAR ETC S4 750W
- Three (3)_____ Fresnel strand 500W with barn doors
- Two (2)_____ Bar Aircraft Par 64 ACL
- Twelve (12)_____ Microh LED BAR II RGB
- Five (5)_____ Microh LED BAR RGB
- Twenty (20)_____ Chauvet COLORado 1-Quad Zoom RGBW LED
- Eight (8)_____ Chauvet COLORdash Batten-Quad 12 LED

Motorized fixtures

- Eight (8)_____ Chauvet Intimidator Hybrid 140SR

Follow spot - on balcony

- One (1)_____ Satellite II 575W follow spot

Accessories

- One (1)_____ DMX splitter Microh (DMXSPLITTER4/19)
- Two (2)_____ DMX splitter Chauvet (Data Stream 4)
- Thirteen (13)_____ B gobo holder
- Two (2)_____ A gobo holder
- Twelve (12)_____ Gobo Rosco 79653
- Two (2)_____ Gobo Rosco 77562
- Twelve (12)_____ Gobo Rosco 79654
- One (1)_____ Gobo Rosco 77794

- One (1) _____ Gobo Rosco 77793
- Two (2) _____ Gobo Rosco 71018
- One (1) _____ Gobo Rosco 78121
- Two (2) _____ Gobo Rosco 78122
- Sixty (60) _____ Gel colors
- Four (4) _____ 100" booms
- One (1) _____ MDG ATMe Hazer
- Sixteen (16) _____ Coupler 1 3/4" to 2" 500kg
- Four (4) _____ Pipe 2" x 84"
- Four (4) _____ Pipe 2" x 100"

Cabling

- Eight (8) _____ DMX5 50' (15m)
- Twenty-five (25) _____ DMX5 25' (7.6m)
- Twenty (20) _____ DMX5 15' (4.6m)
- Ten (10) _____ DMX5 10' (3m)
- Fifteen (15) _____ DMX3 25' (7.6m)
- Ten (10) _____ DMX3 15' (4.6m)
- One (1) _____ Socapex 12 AWG 100'(30.5m)
- One (1) _____ Socapex 12 AWG 65' (20m)
- Three (3) _____ Socapex 12 AWG 50' (15m)
- One (1) _____ Socapex 12 AWG 40' (12m)
- One (1) _____ Socapex 12 AWG 20' (6m)
- Two (2) _____ Socapex 12 AWG 10' (3m)
- Twelve (12) _____ Fan-out Socapex to Stagepin
- Ten (10) _____ Fan-out Socapex to Twist-Lock 20A female
- Twenty-one (21) _____ Twist-Lock 20A 4' - 15' (1.2 - 4.6m)
- Eleven (11) _____ Twist-Lock 20A 25' (7.6m)
- Five (5) _____ Twist-Lock 20A 50' (15m)
- Six (6) _____ Twist-Lock 20A male to U-Ground female
- Five (5) _____ Twist-Lock 20A female to U-Ground male
- Eleven (11) _____ Twist-Lock 20A twofer
- One (1) _____ Feeder cam-lock 3 phase 4/0 AWG 10' (3m)

Focus

- 20' ladder
- 12' step ladder
- Genie DPL-25S electric platform (operator must hold a platform operator licence)

Sound System

Audio desks (FOH)

- Midas M32-Live
- Soundcraft Si Expression3
- iPad with M32-Mix, Mixing Station and Soundcraft control app
- Audio snake Digiflex with VEAM connection 32x8 with monitor split

Main PA

- Eight (8)_____ QSC WL2082-i
- Four (4)_____ QSC WL118-sw
- One (1)_____ Processor QSC SC28

****PA removable on request, rigged with electric chain hoists, max 250kg****

Time-aligned speakers

- Two (2)_____ QSC I-282H (center of the floor)
- Four (4)_____ QSC I-282H (under balcony)

Stage speakers

- Four (4)_____ QSC K12
- Six(6)_____ RCF NX32-A
- Stereo side fill speaker system, Transparence 2x15" with 2" horn and Crown amp

Microphones

- Eight (8)_____ Shure SM58
- Five (5)_____ Shure SM57
- Three (3)_____ Shure PG57
- One (1)_____ Shure PG52
- One (1)_____ Shure MX418D/S
- One (1)_____ Shure Beta 91A
- One (1)_____ Shure Beta 52A
- Two (2)_____ Shure Beta 57A
- Two (2)_____ Shure SM81-LC
- Two (2)_____ Earthworks M-23
- Five (5)_____ Sennheiser e604
- Six (6)_____ Direct box BSS AR-133 active
- Ten (10)_____ Radial JDI passive
- Two (2)_____ C-Ducer for the piano (permanent)

Wireless units

- Three (3) _____ Shure SLX4 receiver (3 beltacks and 2 handheld mics)
- Six (6) _____ Shure UR4D receiver (6 beltacks)

Microphone stands

- Twelve (12) _____ K&M short black stand
- Eighteen (18) _____ K&M tall black stand
- One (1) _____ Atlas chrome

Cabling

- Twenty-three (23) _____ XLR3 50' (15m)
- Thirty-eight (38) _____ XLR3 25' (7.6m)
- Eight (8) _____ XLR3 15' (4.6m)
- Five (5) _____ XLR3 10' (3m)
- Two (2) _____ Digiflex 2x jack 1/4 to 1/8 TRS, 6' (1.8m)
- One (1) _____ Snake XLR 24-8 200' (61m)
- One (1) _____ Snake XLR 24-4 150' (45.7m) (Drum snake)
- One (1) _____ Snake XLR 12x3 100' (30.5m) (Cross-stage)
- Nineteen (19) _____ U-Ground Edison 15A 50' (15m)
- Ten (10) _____ U-Ground Edison 15A 25' (7.6m)
- Four (4) _____ U-Ground Edison 15A 10' (3m)
- Two (2) _____ U-Ground Edison 15A Quad 10' (3m)
- Four (4) _____ U-Ground Edison 15A Quad 25' (7.6m)
- Ten (10) _____ U-Ground Edison 15A Tripler TriTap-K
- Six (6) _____ Furman pro surge suppressor power bar
- Nine (9) _____ Fastlane black cable mat 1 channel drop-over

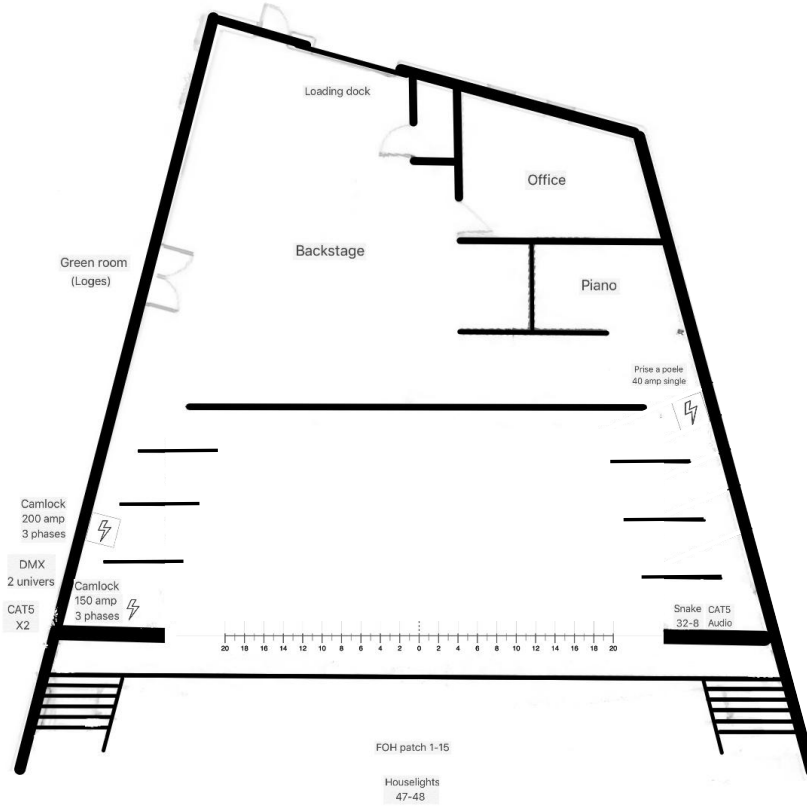

Salle Léo Poulin
Edmundston N.-B.

Marc Soucy
2017

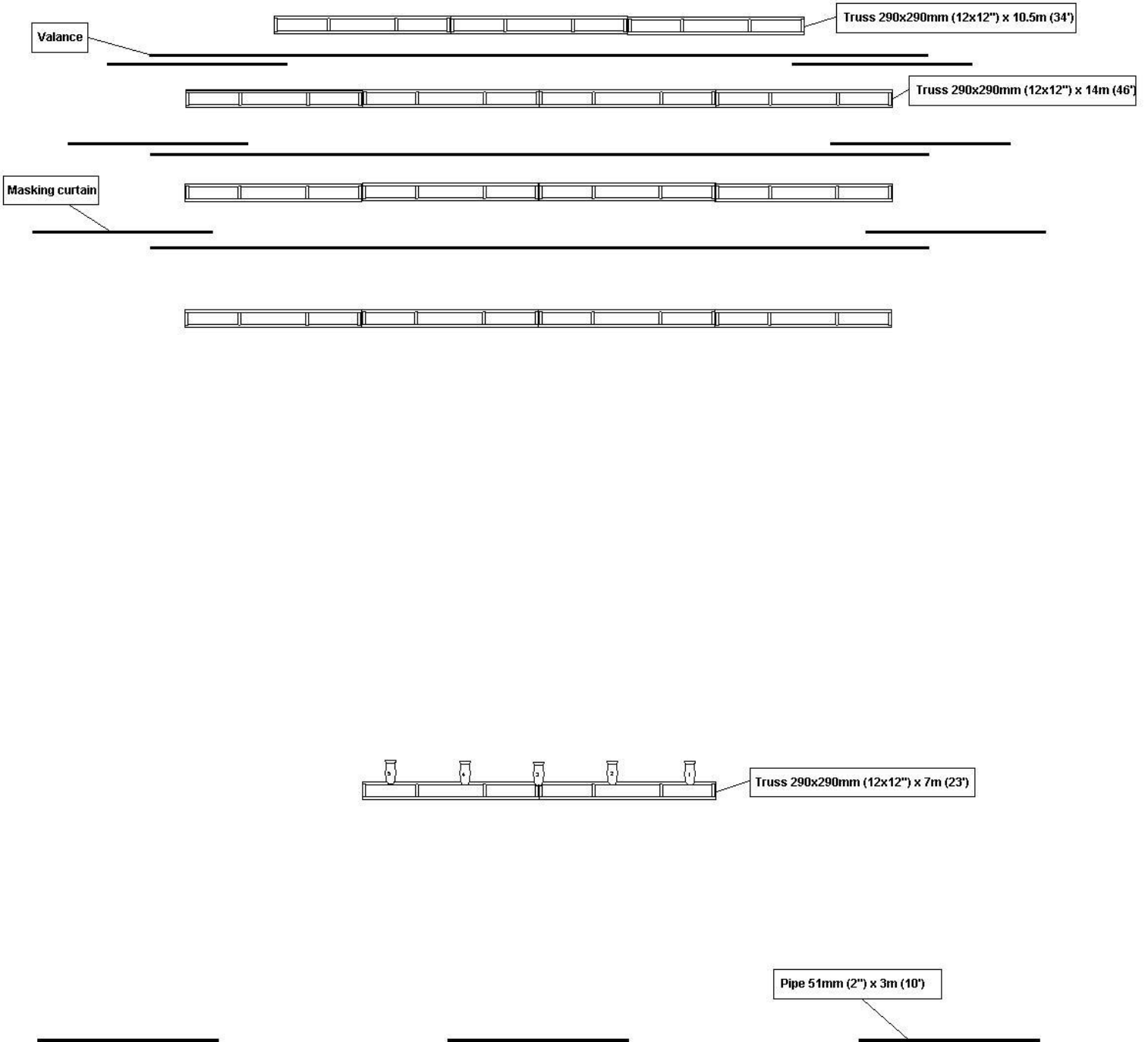

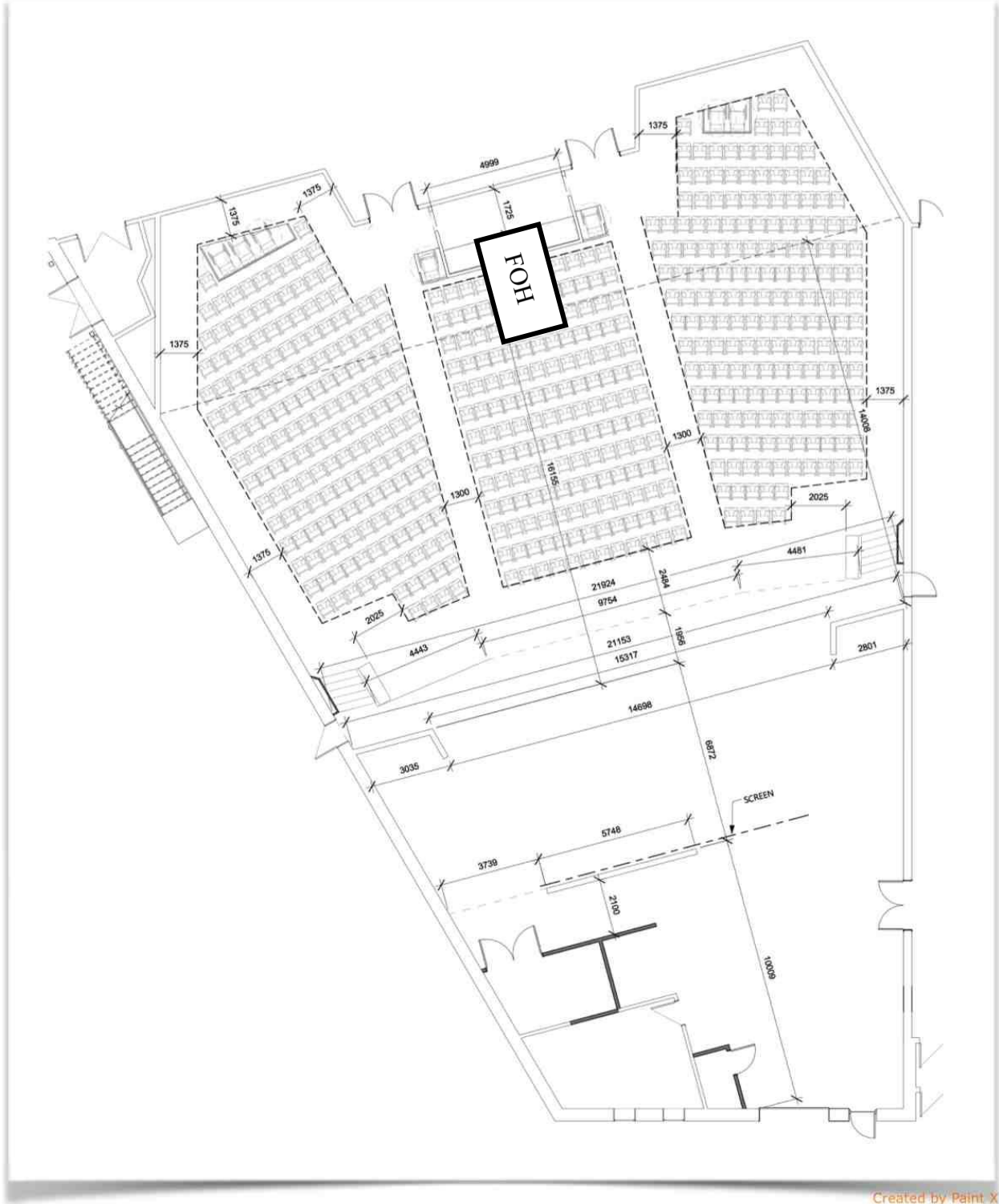

Created by Paint X

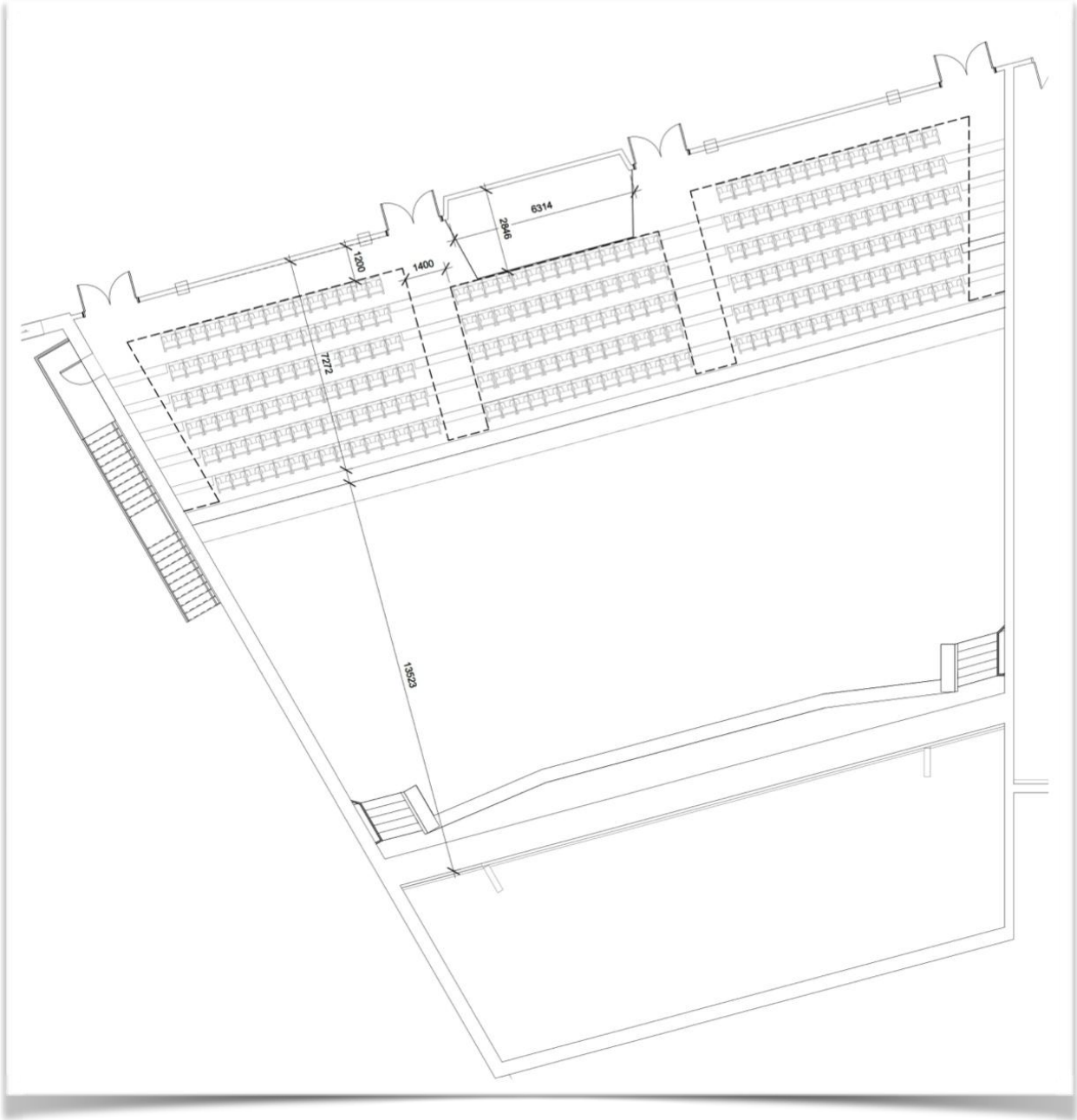

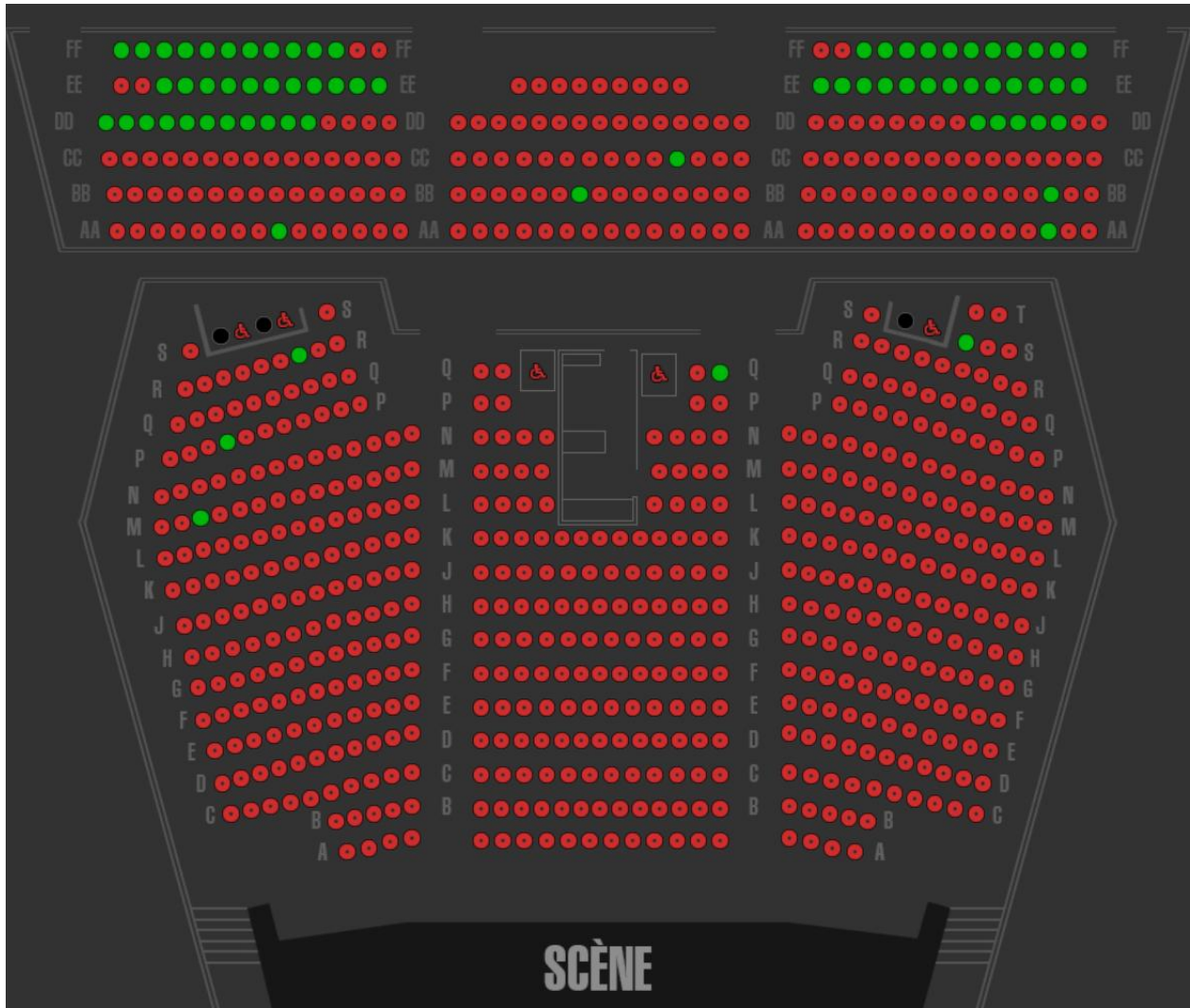

Policy on tobacco-use at the Cité des jeunes A.-M.-Sormany

Since September 1, 2016, the Cité des jeunes A.-M.-Sormany complies with the New Brunswick Smoke-Free Places Act.

It is strictly forbidden to smoke inside the Cité des jeunes A.-M.-Sormany including the salle Léo-Poulin.

In addition, smoking is prohibited outside the Cité des jeunes.

Tenants are responsible for ensuring that all of their participants are aware of this policy and that it is respected.

Information Regarding the Loading Dock



- The dock is at ground level.
- The garage door is 98" wide and 80" high.
- There is a parking space for 1 semi-trailer truck near the loading door.
- The parking lot is available, but is unsecured.

How to get to the loading dock

From Trans-Canada Hwy 2: Exit 18, turn on 15 aout St., entrance CDJ A.-M.-Sormany

